



## SEVEN NINETY

If you're looking for something with slightly more deck space, the CaraBoat 790 could be the perfect option. Internally, it's identical to the smaller CaraBoat 750. However, it relies on a single-engine setup rather than twins, offering more outside space and additional underdeck storage.

### SPECIFICATIONS

Length	7.90M
Width	2.50M
Height Floating	2.10M
Draft	0.20M
Weight	1900Kg
Internal Headroom	1.96M
Suggested Engines	30Hp
Fresh Water Tank	180L
Grey Water Tank	60L
Black Water Tank	19L

### ON TRAILER

Length	9.90m
Width	2.50m
Height	2.85m
Trailer Weight	660kg
Combined Weight	2560kg
Tow Ball Weight	240kg

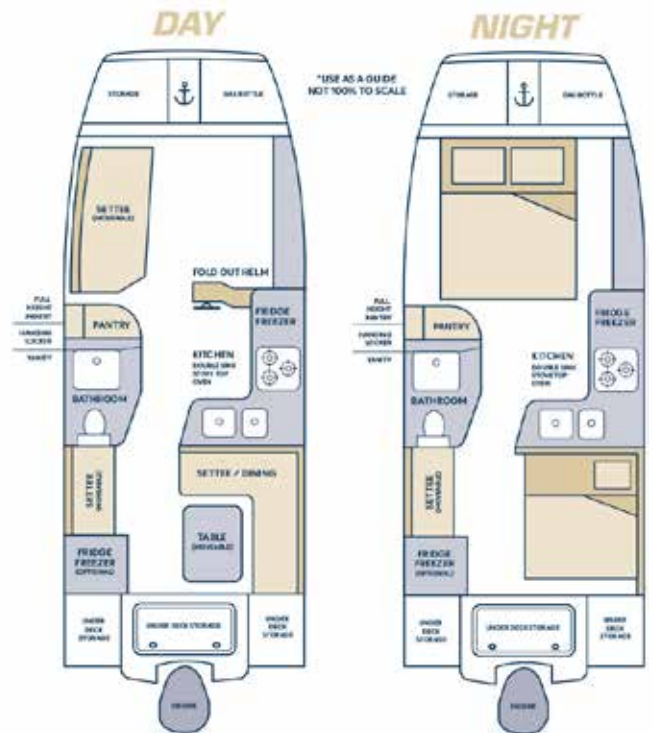

### GALVANISED TANDEM TRAILER

- Main steel frame rails - 200 x 100 x 4mm
- 14" tyres & alloy wheels
- Power assisted hydraulic braking installed
- Spare wheel
- 2 x Removeable wheel arch mud guards
- Height adjustable, swing up Jockey wheel
- 2 x Drop down stabiliser legs - with handle
- 2 x Ratchet straps
- LED submersible trailer lights
- Leaf spring suspension
- 2 x Launching guide poles

### BOATING

- 5 Year warranty on hull
- 1 x 30hp 4 stroke outboard engine
- Fold away steering helm
- Hydraulic steering
- LED Navigation lights
- 6kg anchor with chain & rope
- Electric anchor winch
- 2 x 25L Fuel tanks
- 4 x Stainless steel folding cleats
- 2 x Fenders
- 2 x Mooring lines
- Bilge pump
- Fire Extinguisher
- Lifejackets & safety equipment

### PLUMBING

- 180L Water tank
- 80L Grey water tank
- 14L gas hot water system
- 4kg gas cylinder
- Water pressure pump

### ELECTRICAL

- 240-volt AC power inlet
- 240-volt double AC power outlet
- 2 x 12-volt power outlet
- 2 x USB Charges
- 1 x AGM (Absorbed Glass Mat) batteries
- 2 x Lithium Batteries
- Battery Charger 240v - 15amp
- Solar panel - roof mounted
- Switch panel
- Battery selector / isolator
- Regulator
- Smoke alarm

### BATHROOM

- Non slip, closed cell EVA foam in shower area
- Dometic cassette toilet - 19 Litre
- Combination tap / shower head
- Vented roof hatch
- Mirrored vanity cupboard & lighting
- Automatic sump pump

### KITCHEN / GALLEY

- 118L fridge / freezer
- 3 Burner Smev gas cooktop
- Under bench gas oven/grill
- Range hood 12v with LED downlights
- Stainless steel sinks and sink mixer
- Gel coated granite look alike bench tops
- Full height pantry - 5 shelves
- Led lighting to pantry
- Quality finished cupboards
- Overhead cupboards
- Set of drawers, soft self-closing

### INTERIOR, COMFORT & ENTERTAINMENT

- LED HD TV 24" on movable bracket
- TV antenna
- LED touch lights through out
- 2 x Double beds convertible
- 2 x LED reading lights
- Quality upholstery in range of colours
- Insect Screen to bow window
- Privacy shutter to bow window
- Stern flywire door
- Window treatments, generally roman blind style
- Tall hanging locker
- Under seating storage

### EXTERIOR GENERAL

- Rear & side LED lighting
- Large opening windows on struts
- Gas outlet
- Lockable external deck storage
- Lockable bow storage
- Choice of Gelcoat colours
- Choice of decal / stickers finishing
- Outdoor hot/cold shower nozzle
- Non slip, closed cell EVA foam on rear deck
- Stainless Steel railing to rear deck